

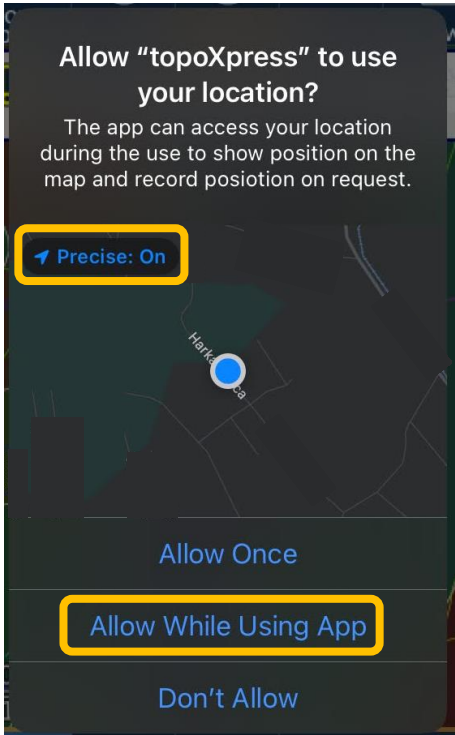

How to set the Precise Location on iOS® version 14 for topoXpress

One of the new privacy features of iOS® version 14 is the ability to set the built-in location provider service to an approximate location. This new feature allows users to share only their approximate location with apps (~5 km) instead of the precise location (~5 m). Since topoXpress is a GIS and Survey application, it requires the precise location for normal operation. Please review your device settings to have the precise location in the topoXpress app if you are on iOS® version 14 :

On a fresh installation from the App Store, the device asks for location service permission. Make sure that the **Precise:** switch is **On** and tap the **Allow While Using App** option at the bottom.



If the app is already installed, review your settings in the **Settings** app:



1. Tap the **Settings** app to open on the home screen

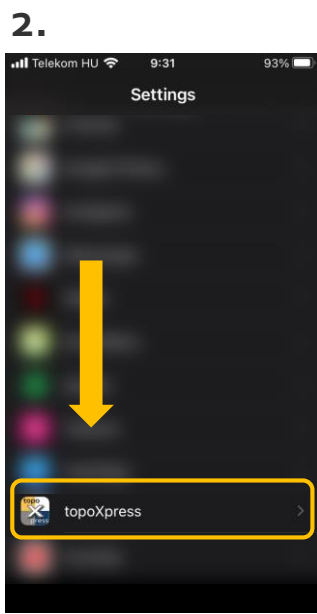

2. Scroll down to the bottom and tap the **topoXpress** app

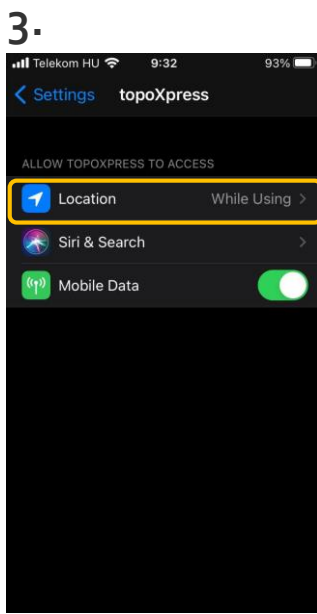

3. Tap the **Location** option

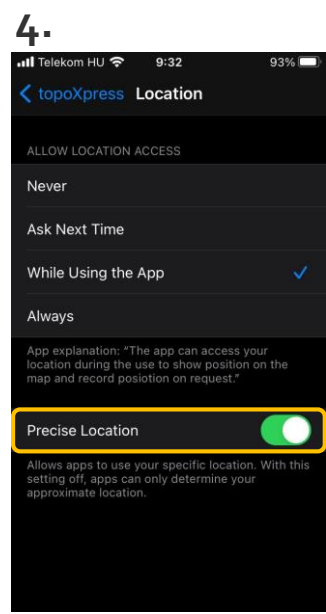

4. Make sure that the **Precise Location** is **ON**